

**IMPORTANT** - LaserMax, Inc., does not warranty the alignment or function of the LaserMax Police Laser sight for ported or compensated firearms, or for firearms which have been altered from stock factory configuration.

**DANGER**

**DANGER** - Laser radiation is emitted from the front aperture of the laser when the switch is activated. Please read the warning label, as found in this manual.

Always observe basic firearm safety rules - point the laser in a safe direction, never at another person.

LaserMax, Inc. strongly recommends that the user of the firearm install the sight. The Laser Sight System becomes an integral part of the firearm, and the user should become as familiar with its installation and use as with the rest of the firearm.

Please note that the Glock 20 and 21 FG/R have a different frame than the older model Glock 20 and 21 and require the LMS-1151PFGR. The older Glock 20 and 21 models are the only Glocks which use a saddle block. The FG/R models do not use a saddle block.

### INITIAL INSPECTION

If the shipping carton is severely damaged, notify the carrier immediately for insurance purposes. Refer to the parts diagram in the back of this manual for a complete listing of included parts.

The LaserMax sighting system is designed to be used with the Glock firearm, lubricated exactly as described in the current version of the Glock Owner's Manual. Excess lubricant can interfere with the proper function of both the firearm and the laser sight, as can inadequate lubricant.

#### STEP 1 - FIELD STRIP YOUR FIREARM

If you are not familiar with field stripping, as described in the Glock Owner's Manual, see Appendix A, on page 8 of this manual.

#### STEP 2 - REMOVE FACTORY SLIDE LOCK

Press the slide lock spring down as far as possible, directly in front of the slide lock, using the installation tool provided, *figure 1*.

Remove the slide lock by pushing it sideways through the receiver while depressing the slide lock spring. (Save your Glock factory parts for possible later use.)

Turn the receiver upside down and tap on a flat surface. If the slide lock spring does not fall out when the receiver is turned upside down, use the installation tool or tweezers to pry or pull the spring out.

#### STEP 3 - INSTALL THE LASERMAX SLIDE LOCK SPRING AND SLIDE LOCK/LASER SWITCH

Install the new slide lock spring in the slot of the frame and use the installation tool to push the smooth end of the spring firmly down into the socket as far as possible, *figure 2*.



Figure 1

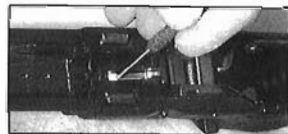

Figure 2

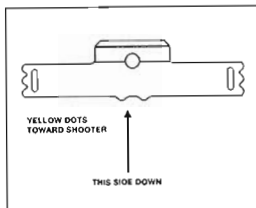

Figure 3

Now insert the laser switch/slide lock, part number LMS-100. *figure 3* shows the proper orientation of the Slide Lock/ Switch. It is very important that the slide lock be installed correctly with the yellow dots facing back toward the shooter. Improper installation will not lock the slide on the frame.

For the Glock 20/21 (Pre FGR only), install the saddle block in the same slot as the slide lock spring in the orientation shown in *figure 4*. Be sure that the curved portion is seated against the contour of the spring guide channel.

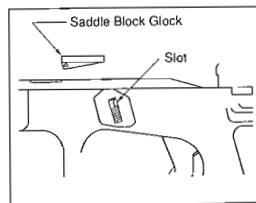

Figure 4

Test the action of the new laser switch by pressing it sideways in both directions. There should be three distinct "click" positions felt. Center the slide lock/laser switch in the frame before installing slide assembly.

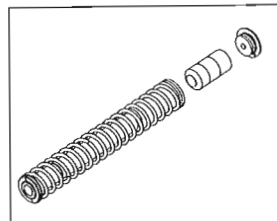

Figure 5

#### STEP 4- INSTALL BATTERIES AND BATTERY CAP

Your LaserMax guiderod comes with a new battery pack preinstalled. For subsequent battery installations: Put your thumb against the wide side of the keel from the side and push up to remove your battery cap. Insert LaserMax battery pack into the battery compartment with the flat side (+) facing out. Refer to *figure 5* when placing the battery cap onto the tube.

Be sure the gold-plated battery contact is in the cap.

The rear of the laser tube has a notch in it that lines up with a key on the cap. Put the key near, but not on, the notch. Push in gently and turn to seat the cap with tab in notch.

#### STEP 5 - INSTALL THE LASERMAX LASER SPRING GUIDE

*Protective Glasses are recommended during installation.*

**CAUTION** - The sight may turn on when installed properly in the slide. Always make sure the sight is pointed in a safe direction.

Firmly grasp the assembled sight by the battery cap and insert the assembly into the slide while pushing forward and down. The battery cap has a keel-like protrusion, which should point straight up. When installing the laser spring guide, be sure that the flat on the battery cap end of the laser spring guide rests in the half moon cut in the bottom of the front barrel lug as shown in *figures 8 & 9*. With the magazine still removed, reassemble the slide to the frame pulling the slide to rear.

Cycle the action. The slide lock should return to the top of the slide lock notch. If resistance is felt during assembly, do not force. Remove the slide and make sure that the laser assembly is positioned as required, then attempt assembly again.

Cycle the slide fully several times allowing the slide to go forward under full pressure of the recoil spring to make sure that the LMS sight is seated in the frame.

Compare your laser sight to your iron sights to insure proper installation.

That's it! Now test your new LaserMax sighting system.

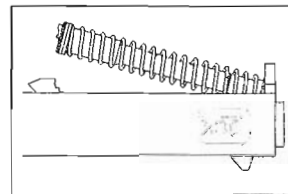

Figure 8

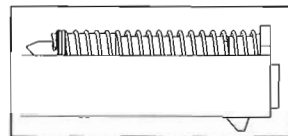

Figure 9



Figure 10

## OPERATION

Point the Pistol in a safe direction, push in the slide lock/laser switch with the trigger finger until a click is felt, *figure 10*. The yellow dot on the switch will be visible.

The laser sight should be projecting a pulsing red beam that closely matches the point of aim of the factory open sights. Turn the laser sight off by pushing the slide lock/laser switch back to the center position. Pressing the slide lock/laser switch to the alternate side will turn the sight on again and expose the yellow dots on the switch.

The laser sight is factory aligned and no further alignment is needed. Your point of bullet impact should be within 2" of your point of laser aim at 20 yards.

## BATTERIES

Our LMS-3x393 batteries power sights with 5A, 5B, 5G, 4A, 4B, and 4G serial numbers. These models use only 3x393 batteries. Replacements are available from your dealer or direct from us. Do not remove the shrink-wrap from LaserMax battery packs. (Three EveryReady 393 batteries may be used in place of LaserMax battery packs).

For longer battery life, avoid getting finger oils on the battery contact surfaces. Operating temperature range for the batteries is from 14 degrees F to 120 degrees F. LaserMax recommends keeping a fresh set of batteries for carry and using older batteries for practice.

## TROUBLE SHOOTING

- 1) Review installation instructions and install a second time to eliminate human error. Pull slide back and allow it to slam forward two or three times to ensure contact.
- 2) Check batteries. Is the + side up? Are they clean and free from oil? If using loose batteries, is the + side up on all of them? Battery voltage for the: LMS-3x393 should be 4.5 volts.
- 3) Check the battery cap. Is there a gold contact in cap?
- 4) Is the slide lock/switch installed correctly? Excessive lubricant can insulate the gun parts and break the circuit.
- 5) If there is still a problem, call the LaserMax Gunsight Technical Support and Warranty Department at 1-800-LASER-03. Technical assistance is available from 9:00 AM to 5:00 PM (Eastern Time) Monday to Friday.
- 6) If the sight has to be returned for repair, call our Warranty Department for a return authorization number before sending the sight. LaserMax will not be responsible for items returned without authorization. Do not return any parts or accessories not requested by the Warranty Department.

## CLEANING AND MAINTENANCE

The window on the muzzle end of the laser may become smoked-over during firing. To clean, **MAKE SURE PISTOL IS UNLOADED AND THE LASER IS OFF**. Clean window with lens cleaner or alcohol on a cotton swab.

LaserMax recommends replacing recoil springs on LMS-1131P and LMS1141P models after 5,000 rounds.

### SAFETY COMPLIANCE LABELING

Operation of a laser without the required safety labeling may violate federal law. The FDA requires the label supplied with your laser be affixed to the outside of the gun with the arrow pointing to the laser aperture. The label contains the required warning for a class IIIA laser, a certification section stating that LaserMax certifies product compliance with FDA regulations, our address, and the month and year of manufacture.

### APPENDIX A- FIELD STRIPPING



Figure 11

Press the magazine catch and remove the magazine.

Clear the chamber by briskly pulling the slide back all the way. Lock the slide back using the slide stop. Check the chamber to ensure that there is no round in the chamber.

Point the pistol in a safe direction, release the slide, then pull the trigger.



Figure 12

Secure the pistol with either hand and wrap all fingers around the slide with the thumb resting on the backside of the receiver.

Draw the slide back about 1/8" and hold while pulling the slide lock to the bottom of its slot with the fingers of other hand, *figure 11*. Both sides of the slide lock must be pulled down at

the same time. If the slide is drawn to the rear more than 1/4", the trigger will reset and the slide will catch on the receiver, preventing removal.

Separate the slide from the receiver by pulling it forward off the receiver, *figure 12*.

Grasp the factory recoil spring guide assembly, slide it forward about 1/8" and lift it clear of the slide assembly. Place it in storage.

### LIMITED WARRANTY

LaserMax, Inc. laser products, except expendable parts, are warranted to be free from defects in material and workmanship for a period of three years from the date of purchase, as shown on the warranty card returned to LaserMax. Expendable parts shall be defined as batteries, springs, and replaceable plastic parts. Expendable parts of some models have definite life expectancies. They should be replaced as recommended to protect the laser and preserve your warranty. This warranty shall benefit, and may be enforced only by the initial purchaser of the laser system and is not transferable. Warranty is limited solely to repairing or replacing the part(s), at the discretion of LaserMax, Inc.; which proves to be defective during the warranty period. Parts and equipment replaced under warranty will not be returned. Parts and equipment repaired under warranty will be covered for the remaining portion of the original warranty period. This warranty does not apply to equipment or parts which upon inspection by LaserMax, Inc. are determined by LaserMax, Inc. to have become defective or unworkable due to abuse, mishandling, misuse, alteration, negligence, improper installation or maintenance, damage resulting from use of springs not supplied with laser, damage resulting from repair or attempted repair by anyone other than LaserMax, Inc. or a repair facility authorized by LaserMax, Inc., or other causes beyond the control of LaserMax, Inc. All returns must have factory labeling present and legible. All returns require a return authorization number available from our Warranty Department at 1-800-LASER-03. The hours of operation are from 9 a.m. to 5 p.m. EST, Monday through Friday.

LASERMAX, INC. DISCLAIMS LIABILITY FOR INCIDENTAL AND CONSEQUENTIAL DAMAGES FOR BREACH OF ANY EXPRESS OR IMPLIED WARRANTY. ANY IMPLIED WARRANTY OF MERCHANTABILITY OR FITNESS FOR A PARTICULAR PURPOSE, WITH RESPECT TO THE LASERMAX, INC. LASER PRODUCT IS FOR A PERIOD OF THREE (3) YEARS FROM DATE OF PURCHASE. THIS WARRANTY GIVES YOU SPECIFIC LEGAL RIGHTS, AND YOU MAY ALSO HAVE OTHER RIGHTS WHICH VARY FROM STATE TO STATE.

## Spare Parts List - LaserMax Glock® Series

GLOCK® Model #	19, 23, 32, 38	17, 17L, 22, 24, 31, 34, 35, 37	20, 21	20, 21 FG/R or SF
High Brightness Model	LMS-1131P	LMS-1141P, LMS-1141LP	LMS-1151P	LMS-1151PFGR
1. Serial # and FDA Warning Label	LMS-300	LMS-300	LMS-300	LMS-300
2. Recoil Spring**	LMS-131P	LMS-141P	LMS-151P	LMS-151P
3. Service Kit (items 4, 5, 7, 8, 9)	LMS-156P	LMS-166P	LMS-176P	LMS-176P
4. Battery Pack*	LMS-3x393	LMS-3x393	LMS-3x393	LMS-3x393
5. Battery Cap	LMS-132P	LMS-142P	LMS-152P	LMS-152P
6. Slide Lock/Laser Switch	LMS-100	LMS-100	LMS-100	LMS-100
7. Slide Lock/Laser Switch Spring	LMS-134	LMS-144	LMS-154	LMS-154
8. Installation Tool for Slide Lock Spring	LMS-125	LMS-125	LMS-125	LMS-125
9. LMS-11XX Series Manual	LMS-110	LMS-110	LMS-110	LMS-110
10. Saddle Block Pre-FG/R Glock 20, 21	N/A	N/A	LMS-111	N/A
11. Shock Buff	LMS-102	LMS-102	LMS-102	LMS-102
12. Captive Spring Bushing (2 halves)	LMS-103	LMS-103	LMS-103	LMS-103
13. Captive Recoil Spring Replacement Kit (including instructions & items 2, 11 & 12)	LMS-135	LMS-145	LMS-155	LMS-155

### LMS-1141-G4 (GLOCK GEN4 26 & 27):

- 12. Captive Spring Bushing (2 halves)
- 13. Captive Recoil Spring Replacement Kit

LMS-103-G4  
LMS-145-G4

\* Production serial numbers starting with 5A, 5B, 5G, 4A, 4B and 4G use 3x393 batteries only! Please call 1-800-LASER-03 for correct batteries to use in other models.

\*\* Recoil springs have a lifetime of 5000 rounds.

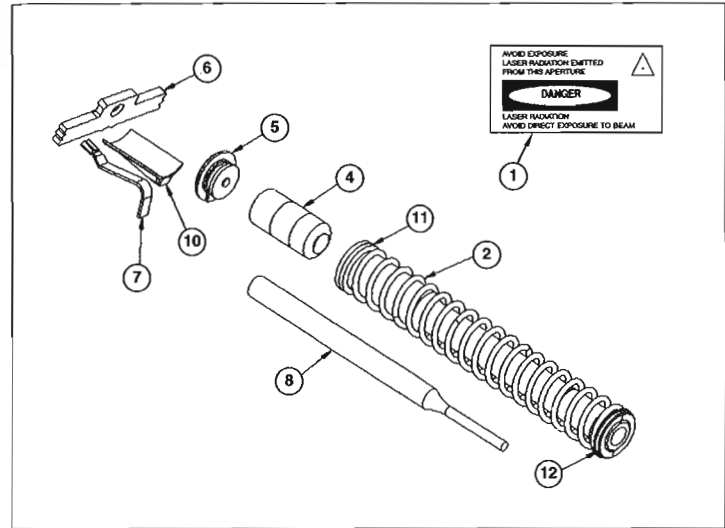

A first-time installation typically takes 20 minutes or less. Subsequent installations and battery replacement can be accomplished in less than a minute. We at LaserMax always strive to bring you superior technology. Please let us know what you think of the LMS Laser Sight by taking a moment to fill out and return your postage-paid warranty card. Again, thank you, from all of us at LaserMax.