

## What's In the Box



- Parts:**
- (A) SABRE
  - (B) BATTERY COVER (LMS-SA-BC)
  - (C) BATTERIES: 357 (2) (LMS-2X357)
  - (D) TRIGGER HOUSING PINS (LMS-SA-MPF) *full size/standard x2*  
(LMS-SA-MPC) *compact x1*
  - (E) INSTALLATION TOOL (LMS-SA-IT)
  - (F) ALIGNMENT TOOL (.050") (LMS-SA-AT)
  - (G) LASER WARNING LABEL

**Note:** Batteries are pre-installed for your convenience.

## Installing the Sabre Laser System

### Figures

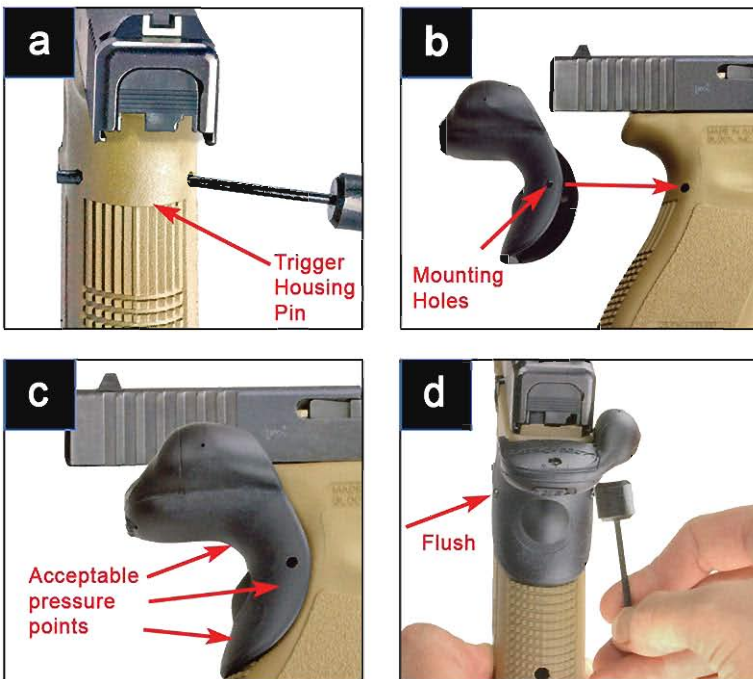

**TIP:** When installing the LaserMax Trigger Housing Pin (Part: D), start to insert the pin on one side of the frame. As you push the pin through the frame (towards you), watch from the other side to make sure the hole in the Sabre line up with the hole in the frame and that the pin pushes through easily and becomes flush with the Sabre.

- 1 Remove the magazine from your firearm. Clear the action. Make sure your gun is unloaded. (Physically and visually inspect for any possible rounds).
- 2 Check again.
- 3 Lock back the slide and using the Installation Tool (Part: E) provided, push the factory installed Trigger Housing Pin out of your firearm. (See figure a) Store Trigger Housing Pin in case it is needed in the future.
- 4 **Warning:** During steps 4-6, it is important that you **DO NOT** apply pressure to the rubber button. Position the Sabre against the back of the grip of your firearm (See figure b) and align the mounting holes in the Sabre with the holes in the frame where the factory Trigger Housing Pin was removed. You should see light through the holes when lined up correctly.
- 5 While applying pressure on both sides of the Sabre to hold it in place against the firearm (See figure c for acceptable pressure points), insert the LaserMax Trigger Housing Pin (Part: D) through the holes. **Note:** For LMS-SA-GF (full-size/standard) model, start with the smooth LaserMax Trigger Housing Pin (Part: D). If installation of pin is difficult, use the ribbed LaserMax Trigger Housing Pin (Part: D) with the tapered ends.
- 6 Return slide to the forward position and use the larger end of the Installation Tool (Part: E) to seat the pin correctly. The pin **MUST** be flush with the surface of the Sabre on both sides. (See figure d)

## Activating the Sabre Laser System

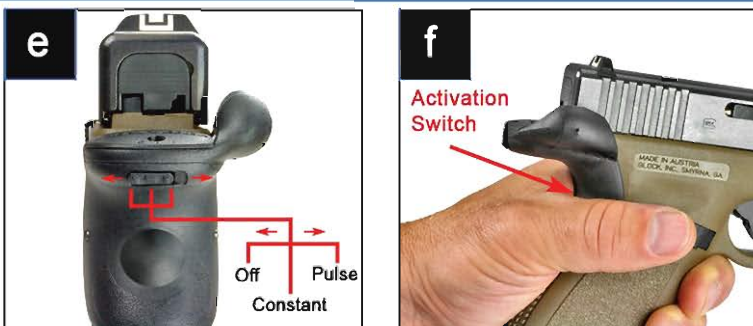

- 1 Select a position on the Mode Selection Switch located on the back of the battery housing of the Sabre. There are three positions that can be selected: Off (left), Constant Beam (middle), Hi-Visibility Pulsating Beam (right). (See figure e)
- 2 Once an active position is selected (Constant or Pulsating beam), gripping your firearm normally and applying pressure on the activation switch (See figure f) will activate the laser until pressure is released, which will then deactivate the laser.

## Aligning the Sabre



The hole at the top adjusts elevation (vertical alignment). A clockwise turn shifts laser up.



The hole at the side adjusts windage (horizontal alignment). A clockwise turn shifts laser to the right.



You can easily fine tune your laser to accommodate your GLOCK firearm, type of ammunition or shooting distance.

**\*Important:** During alignment, you should hold your firearm in your firing hand, and adjust the alignment with your non-firing hand. This alignment should be done at a minimum distance of ten (10) yards. A one-quarter (1/4) turn equals approximately three (3) inches at ten (10) yards.

- 1 To sight in your laser, insert the Alignment Tool (Part: F) into one of the small alignment ports on the outside of the Sabre (Part: A)
- 2 Align laser by slowly turning the Alignment Screws with the Alignment Tool (Part: F), until laser aligns with your fixed sights. (See figures g & h) Figure i shows how to properly make adjustments to alignment.

**Warning:** Do not turn Adjustment Tool (Part: F) more than **one** complete turn from factory position. This may cause damage to the Sabre and may void your warranty.

**NOTE:** When installing Sabre for the first time, a slight shift in alignment may be noticed after firing, due to settling. Recheck alignment after firing a few magazines and readjust if necessary.

## Changing the Batteries & Cleaning



Note correct orientation as marked inside battery compartment

(Left) Positive side up. (Right) Positive side down.

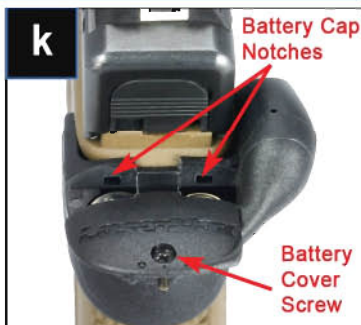

- 1 Unscrew battery cover screw (See Figure k) from Battery Cover (Part: B)
- 2 Remove Battery Cover (Part: B) from Sabre (Part: A) and insert Batteries (Part: C) into unit as shown. (See figure j)
- 3 Return Battery Cover (Part: B) to original position, making sure the tabs on the cover are inserted into the Battery Cap Notches in Sabre (Part: A). (See figure k)
- 4 Tighten battery cover screw back into Battery Cover (Part: C). Do not over tighten.

**Cleaning:** To clean Sabre simply wipe laser lens with a cotton swab moistened with isopropyl alcohol

## Limited Warranty

LaserMax, Inc. laser products, except expendable parts, are warranted to be free from defects in material and workmanship for a period of three years from the date of purchase, as shown on the warranty card returned to LaserMax. Expendable parts shall be defined as batteries, springs, and replaceable plastic parts. Expendable parts of some models have definite life expectancies. They should be replaced as recommended to protect the laser and preserve your warranty. This warranty shall benefit, and may be enforced only by the initial purchaser of the laser system and is not transferable. Warranty is limited solely to repairing or replacing the part(s), at the discretion of LaserMax, Inc.; which proves to be defective during the warranty period. Parts and equipment replaced under warranty will not be returned. Parts and equipment repaired under warranty will be covered for the remaining portion of the original warranty period. This warranty does not apply to equipment or parts which upon inspection by LaserMax, Inc. are determined by LaserMax, Inc. to have become defective or unworkable due to abuse, mishandling, misuse, alteration, negligence, improper installation or maintenance, damage resulting from use of springs not supplied with laser, damage resulting from repair or attempted repair by anyone other than LaserMax, Inc. or a repair facility authorized by LaserMax, Inc., or other causes beyond the control of LaserMax, Inc. All returns must have factory labeling present and legible. All returns require a return authorization number available from our Warranty Department at 1-800-LASER-03. The hours of operation are from 9 a.m. to 5 p.m. EST, Monday through Friday.

LASERMAX, INC. DISCLAIMS LIABILITY FOR INCIDENTAL AND CONSEQUENTIAL DAMAGES FOR BREACH OF ANY EXPRESS OR IMPLIED WARRANTY. ANY IMPLIED WARRANTY OF MERCHANTABILITY OR FITNESS FOR A PARTICULAR PURPOSE, WITH RESPECT TO THE LASERMAX, INC. LASER PRODUCT IS FOR A PERIOD OF THREE (3) YEARS FROM DATE OF PURCHASE. THIS WARRANTY GIVES YOU SPECIFIC LEGAL RIGHTS, AND YOU MAY ALSO HAVE OTHER RIGHTS WHICH VARY FROM STATE TO STATE.

## SPARE PARTS LIST:

LMS-SA-AT: Alignment Tool (Part: F)  
LMS-SA-IT: Installation Tool (Part: E)

LMS-SA-MPF: Trigger Housing Pins - full size (Part: D)  
LMS-SA-MPC: Trigger Housing Pin - compact (Part: D)

LMS-SA-BC: Battery Cover (Part: B) - includes screw  
LMS-2X357: Batteries: 357 (2) (Part: C)

LMS-SA-GC - compact  
LMS-SA-GF - full size (standard)  
**CLASS 3R VISIBLE LASER PRODUCT**  
Output: <5mW  
Wavelength: 635 nm



**Warning:**  
Avoid direct exposure to beam

MANUFACTURED BY  
LASERMAX, INC.  
3495 WINTON PLACE  
ROCHESTER, NY 14623 USA

Reminder: Aiming laser beam at moving vehicles including boats, aircraft, trains, and construction equipment may be illegal. Check current applicable laws and follow them accordingly.

Complies with 21CFR1040 per Laser Notice 50 (2001)