

PARTS IDENTIFICATION

Right Housing

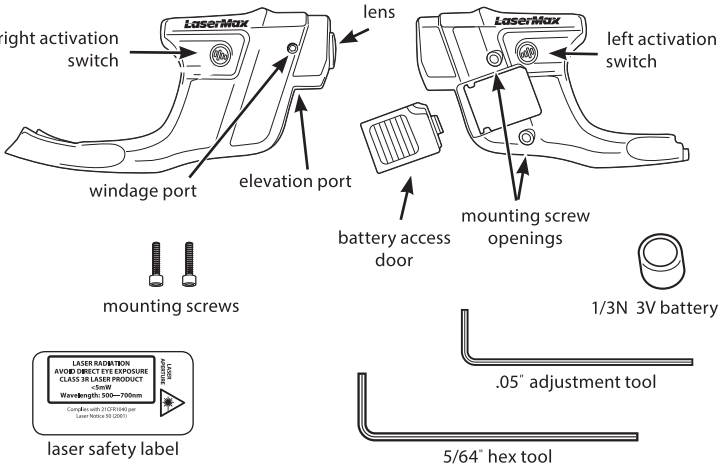

You Tube See this sight installed at www.youtube.com/LaserMaxInc.

! IMPORTANT: Prior to installation, battery change, cleaning or maintenance, follow the firearm operator's manual to ensure that the firearm is unloaded.

INSTALLATION

! This state-of-the-art laser sighting system is designed for use with a specific pistol platform. Do not attempt installation on any other firearm models.

Place rear portion of *right housing* on trigger guard of pistol as shown (figure 1).

While applying upward pressure to rear portion, press *right housing* firmly into place aligning channel in *right housing* with trigger guard (figure 2).

Insert rear portion of *left housing* into the *right housing* at a 45 degree angle (figure 3).

Mate left housing with right housing, press together to remove gap.

Install two (2) *mounting screws* into left housing with 5/64 *hex tool* (figure 4). Next, tighten each *mounting screw* until secure. Do not over-tighten; this may damage the CenterFire® housing.

Install battery and battery door as described in BATTERY REPLACEMENT.

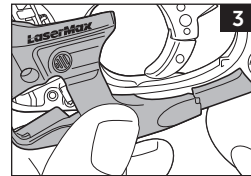
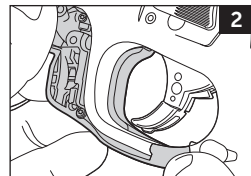
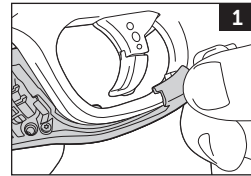

OPERATION

Switch Activation - To turn the laser on, press in and release the *activation switch* on either side (figure 5). Press and release again to turn the laser off.

To switch aiming point from pulse to steady, press and release the *activation switch* from either side to activate the laser. Then, press and hold the *activation switch* for 3 seconds. The laser mode will change. Repeat the process to return to the previous mode.

GripSense Activation - When hand is within the *detection zone*, the unit will turn on (figure 6). When hand is removed from the *detection zone*, the unit will turn off. The laser can also be turned off by pressing and releasing either *activation switch*. To turn back on, press and release either *activation switch* or remove hand from the grip and re-grip the firearm.

To set GripSense Activation Mode, turn unit off. Make sure neither hand is in the *detection zone*, then press and hold both *activation switches* at the same time (figure 7) for five seconds or until the laser flashes once for *GripSense Activation* disabled or twice for *GripSense Activation* enabled.

NOTE: To save power and prevent inadvertent battery drain, the laser will automatically shut off after being left on continuously for 10 minutes.

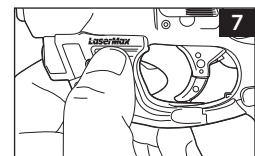
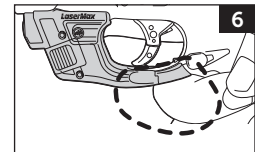
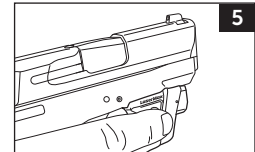
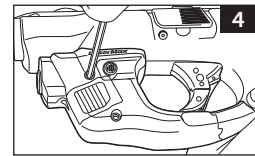

ALIGNING THE LASER

Verify proper alignment by comparing laser aiming point to iron sights at a distance of 10 yards for initial alignment. The laser dot should be slightly above the iron sights.

To make adjustments, insert *alignment tool* into one of the two alignment ports (figures 8) and slowly rotate the tool while comparing laser position on target to fixed sights. **Important:** Do not rotate *alignment screws* more than one full turn in either direction from the factory position. This may cause damage to the laser and void the warranty. A one quarter turn will result in a movement of approximately 3 inches at 10 yards.

Windage adjustment: with the muzzle pointing forward and the *adjustment tool* inserted into the adjustment port on the upper right side, a clockwise turn will shift the laser aiming point to the left and a counterclockwise turn will shift the laser beam to the right (figure 8).

Elevation adjustment: with the muzzle pointing forward and the *adjustment tool* inserted into the *alignment port* on the bottom, a clockwise turn, as viewed from the bottom, will shift the laser beam down and a counterclockwise turn will shift the laser beam up (figure 9).

NOTE: a slight shift in alignment may be observed after firing CenterFire laser for the first time. Recheck alignment after break in and readjust as necessary.

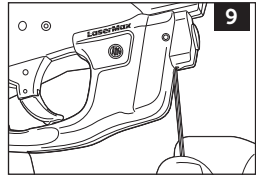
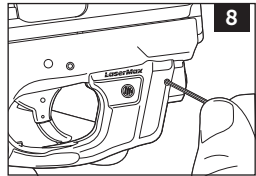

BATTERY REPLACEMENT

Push in on battery cover to release interlock, then slide down to remove (figure 10). Remove battery.

Keeping hand away from *detection zone*, install a fresh 1/3N 3V lithium battery with the positive (+) facing coiled spring (figure 11).

Before replacing battery cover, make sure neither hand is in the *detection zone*. Put battery cover in place, press in and slide battery cover toward barrel.

! If hand is in *detection zone* when replacing battery cover, *GripSense Activation* will not work initially. Remove hand from unit and regrip. Now *GripSense Activation* will work.

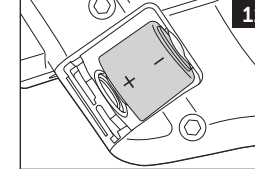
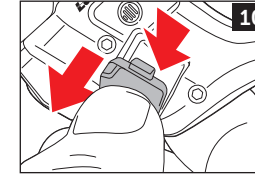

CLEANING

After repeated fire, the lens may become clouded with gunpowder residue. For best results, it is recommended that this area be cleaned, along with the firearm, after each use. To clean the lens, follow these steps.

Keep firearm pointed in a safe direction

Confirm laser is off.

Dampen the end of a cotton swab with isopropyl alcohol.

Apply dampened swab to lens and polish in a small circular pattern. Be sure to clean around edges of lens.

BATTERY WARNING

This product uses a 1/3N battery with a Nominal Voltage of 3 Volts
Battery Type: 1/3N, Nominal Voltage:3.0V

- Remove and immediately recycle or dispose of used batteries according to local regulations, and keep away from children. Do not dispose of batteries in household trash or incinerate.
- Even used batteries may cause severe injury or death.
- Call a local poison control center for treatment information.
- Non-rechargeable batteries are not to be recharged.
- Do not force discharge, recharge, disassemble, heat above 140°F or incinerate. Doing so may result in injury due to venting, leakage, or explosion resulting in chemical burns.
- Do not mix old and new batteries, or mix different brands or types of batteries such as alkaline, carbon-zinc or rechargeable batteries.
- Remove and immediately recycle or dispose of batteries from equipment not used for an extended period of time according to local regulations.
- Always completely secure the battery compartment. If the battery compartment does not close securely, stop using the product, remove the batteries, and keep them away from children.
- Ensure the batteries are installed correctly according to polarity (+ and -).

⚠ WARNING

- INGESTION HAZARD:** This product contains a button cell or coin battery. **DEATH** or serious injury can occur if ingested. A swallowed button or coin battery can cause **Internal Chemical Burns** in as little as **2 hours**. **KEEP** new and used batteries **OUT OF REACH OF CHILDREN**. **Seek immediate medical attention** if a battery is suspected to be swallowed or inserted inside any part of the body.
- Battery type:** 1/3N
Normal voltage: 3 Volt



REPLACEMENT PARTS

06315-3-1	GS-LC9 battery access door (Ruger)
06309-3-1	GS-SHIELD battery access door (Smith & Wesson)
04816-A-1	.05" adjustment tool
06297-0-1	5/64 hex tool
06233-0-1	3/8" mounting screw (Smith & Wesson)
06234-0-1	1/2" mounting screw (Ruger)

LASERMAX PRODUCTS LIMITED WARRANTY

AsusMax is pleased to offer a five (5) year limited warranty for this product. To take advantage of this coverage, the product must be registered no later than 90 days after purchase.

This product may be registered by completing a Registration Form which may be found at www.lasermax.com/support or by contacting the LaserMax Customer Service Department at 1-800-527-3703. The LaserMax Limited Warranty extends specific legal rights to the registrant. Other rights, which vary from state to state, may also apply. This product is warranted to be free from defects in material and workmanship at the time of purchase. This limited warranty does not cover expendable parts (ex: batteries), that have definite and predictable life expectancies. This warranty does not cover products that LaserMax determines have been exposed to abnormal use in any way. Examples of abnormal use include, but are not limited to, damage from mishandling, misuse or abuse, damage from exposure to abnormal conditions, damage from improper care and maintenance, or installation of the product in or on any firearm model the product is not specifically advertised to be used with. Warranty coverage begins on the date of purchase and ends five (5) years after date of purchase. This limited warranty extends only to the original registrant and is non-transferable. To file a warranty claim, a warranty repair request must be submitted, and a Return Merchandise Authorization (RMA) number issued by the LaserMax Warranty Department, within five (5) years from date of purchase. Following submission of a warranty claim, LaserMax reserves the right to inspect the product to determine its eligibility for warranty coverage. If deemed eligible, LaserMax will repair or replace the part(s)/product that LaserMax, at its sole discretion, determines to be defective during the warranty period. If deemed ineligible, LaserMax will return the part(s)/product with an explanation of why coverage is not available. LaserMax reserves the right to replace defective part(s)/product with an equivalent substitute product at its sole discretion. Any and all implied warranties, including the implied warranties of merchantability, fitness for a particular purpose, and non-infringement, also begin on the date of purchase and end five (5) years after date of purchase. This limitation does not apply to residents of states that disallow limitations on the length of implied warranties. The preceding process is both the exclusive remedy and LaserMax's exclusive liability for any warranty claim. LASERMAX WILL NOT, UNDER ANY CIRCUMSTANCES, BE LIABLE FOR ANY INCIDENTAL, INDIRECT, CONSEQUENTIAL, PUNITIVE OR EXEMPLARY DAMAGES (EVEN IF LASERMAX HAS BEEN NOTIFIED OF THE POSSIBILITY OF SUCH DAMAGES) RESULTING FROM OR RELATED TO A PRODUCT, INCLUDING, WITHOUT LIMITATION, ANY LOSS OF PROFIT, OPPORTUNITY, OR DAMAGES IN EXCESS OF THE PURCHASE PRICE OF THE WARRANTED PRODUCT. THIS LIMITATION DOES NOT APPLY TO RESIDENTS OF STATES THAT DISALLOW LIMITATIONS ON INCIDENTAL OR CONSEQUENTIAL DAMAGES.



**IF YOU EXPERIENCE AN
ISSUE WITH YOUR LASER
PLEASE DO NOT RETURN IT
TO THE STORE.**

Contact LaserMax Customer Service: 800-527-3703



Green Laser
CLASS 3R VISIBLE LASER
Output Power: <5mW
Wavelength: 500–700nm

REMINDER

Aiming a laser beam at moving vehicles including boats, aircraft, trains, and construction equipment may be illegal. Check current applicable laws and follow them accordingly.

WARNING

Avoid direct eye exposure to beam. Do not point laser at anything you do not wish to destroy.

NOTICE:

The FDA requires the label supplied with your laser be affixed to the outside of the gun near the laser aperture.

DANGER

Laser radiation is emitted from the front aperture of the laser when the switch is activated.

Rogers, AR 72756 USA
www.LaserMax.com

For patent information, please visit:
www.lasermax.com/patents
 GS-515 04/25



CENTER**FIRE**®
LASER SIGHT



USER GUIDE

Ruger® LC9S® | LC9® | LC380®
S&W® M&P® SHIELD™ 9mm | .40 S&W®

GS-LC9S-G
GS-SHIELD-G